

**COMFORT**  
WORKSPACE



**POFIT**  
USER GUIDE **app**





# USER GUIDE

## Content



PARTS LIST

3-4



ASSEMBLY INSTRUCTIONS

5-8



FUNCTION CONTROLS

9-26



HEALTHY & SMART APP

27-44



CARE & MAINTENANCE OF UPHOLSTERY

45-46

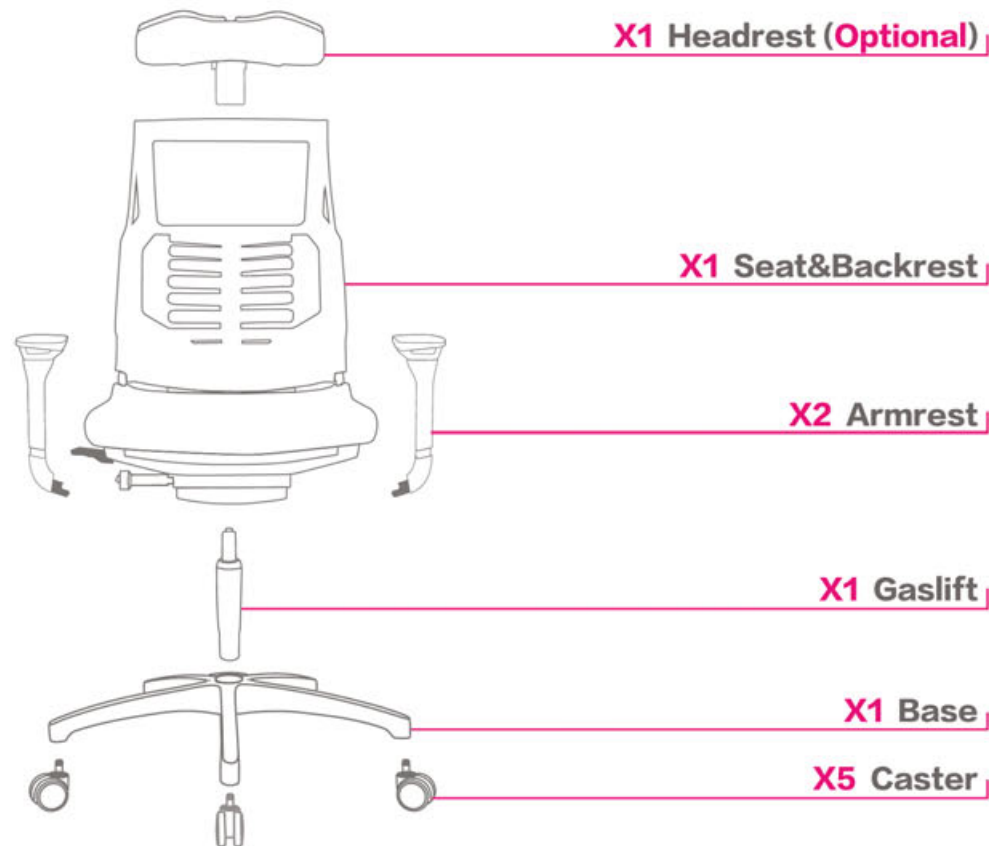
**ALLEN WRENCH X1****X4 1/4 X 16mm (ARMREST)**  
**X1 1/4 X 16mm (SPARE)**

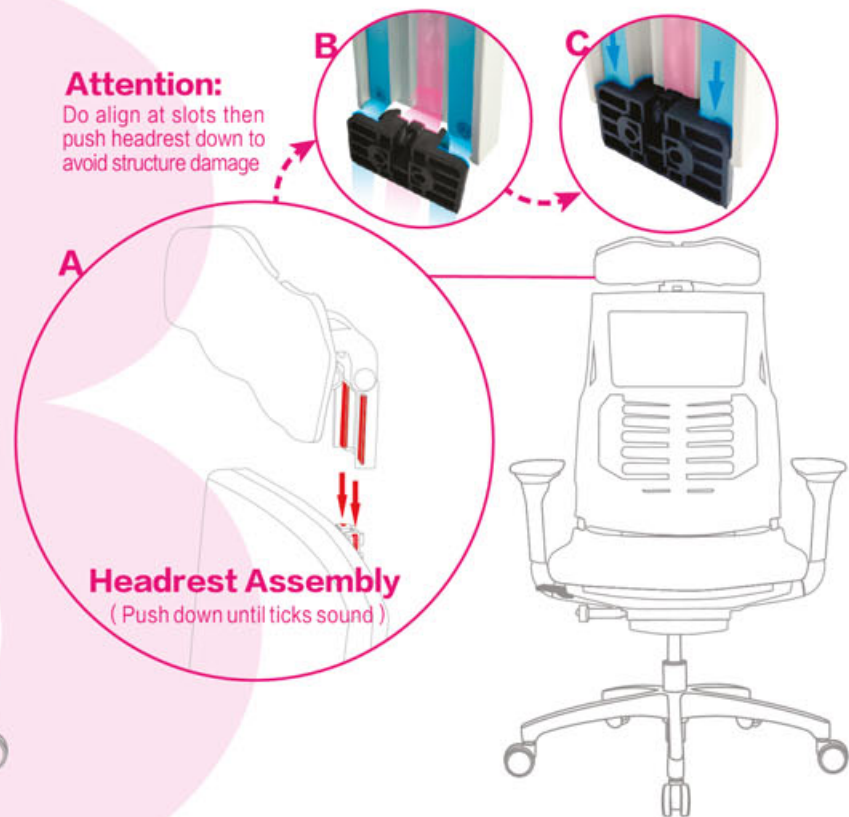
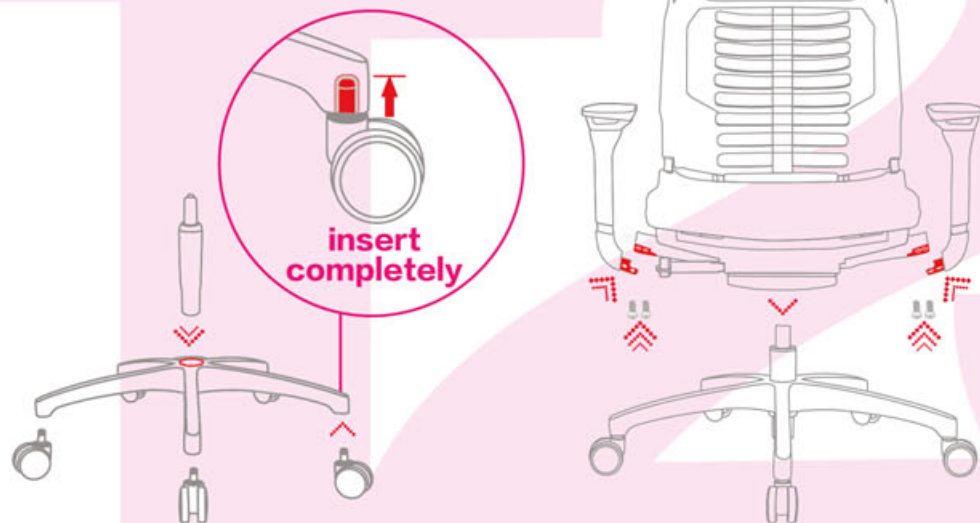

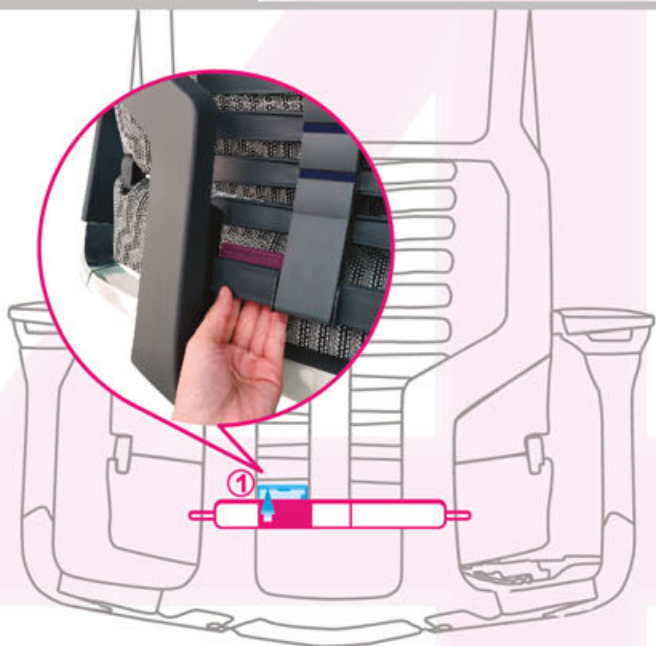

- ① Push up the battery box to disassemble it

### AAA Backrest & Seat



- ② Turn over the battery box, push the battery box cover out as per arrow direction to install batteries



- ③ Slide the battery box from top to bottom to fix it

- ① Slide the seat depth to the forefront

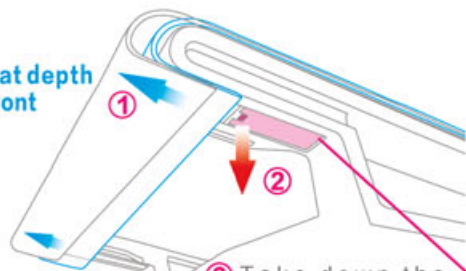

- ② Take down the battery box cover

- ③ Install batteries

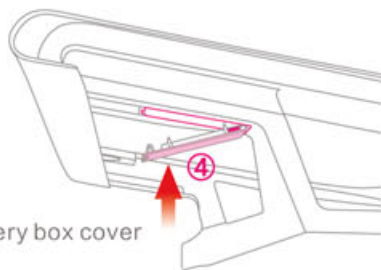

- ④ Fit the battery box cover

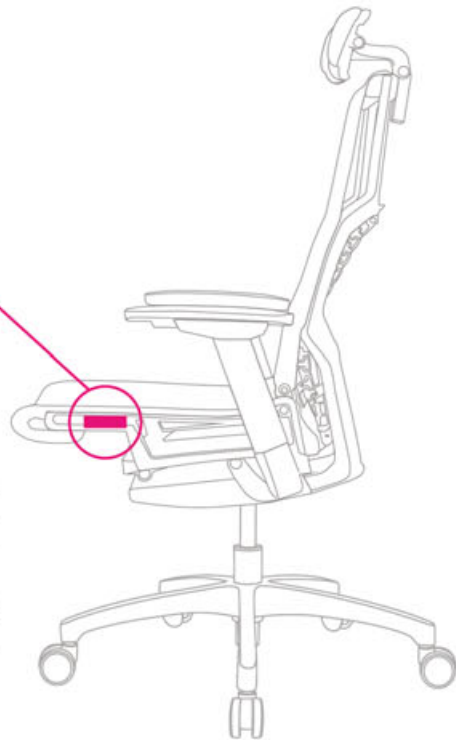



# FUNCTION CONTROLS

- 1 SINGLE LEVER CONTROL**
  - SEAT HEIGHT ADJUSTMENT
  - BACK TILT & LOCK ADJUSTMENT
- 2 TWO BACK TILT TENSION MODES ADJUSTMENT**
- 3 PROTECTING LUMBAR POSITIONS ADJUSTMENT**
- 4 3D ARMREST & SEAT DEPTH**
- 5 LIVEMOTION LUMBAR AUTO-TRACKING SYSTEM**
- 6 5D HEADREST(OPTIONAL)**
- (7) HEALTHY & SMART APP**



1 2 FUNCTION CONTROLS

INTUITIVE ADJUSTMENT

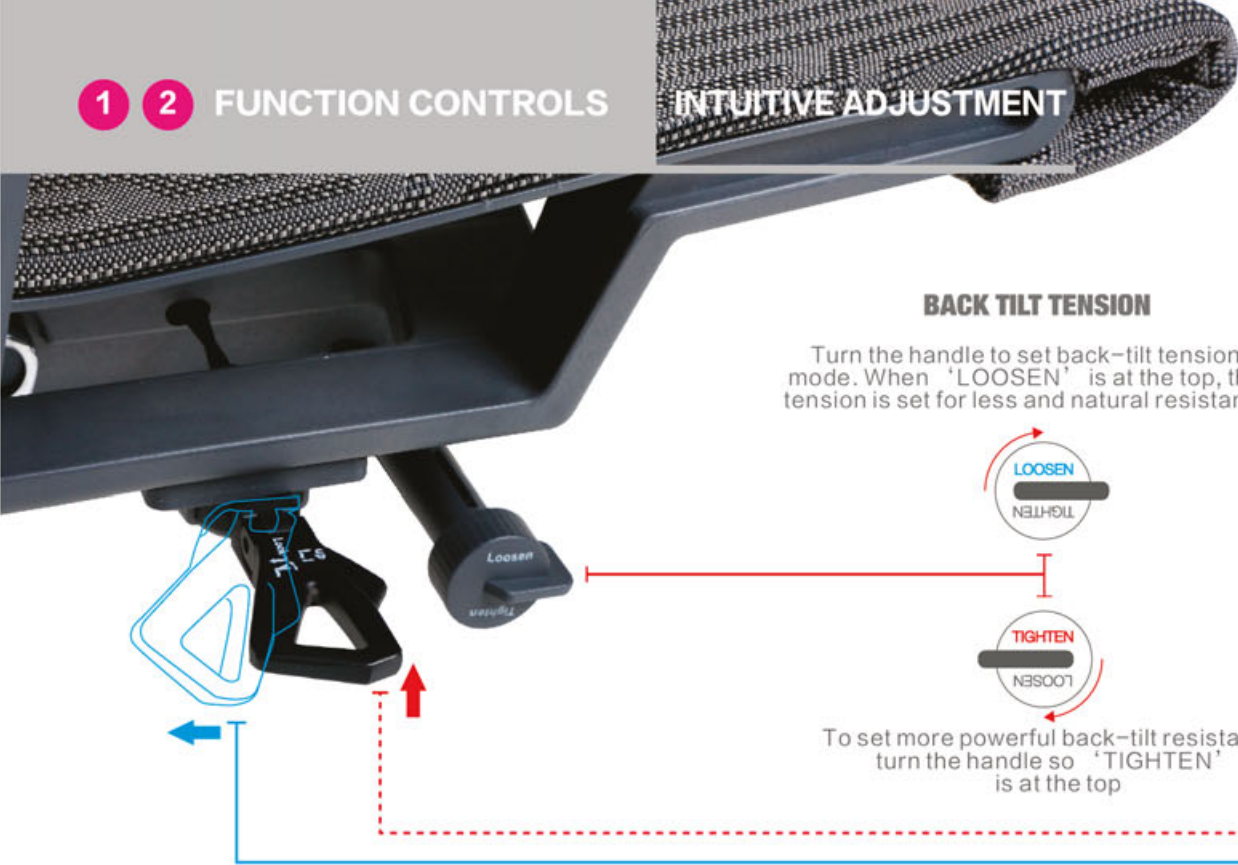

BACK TILT TENSION

Turn the handle to set back-tilt tension mode. When 'LOOSEN' is at the top, the tension is set for less and natural resistance



To set more powerful back-tilt resistance, turn the handle so 'TIGHTEN' is at the top

SEAT HEIGHT



Pull the lever up and hold to raise or lower seat height. Release the lever to lock seat in position

BACK TILT



Push the lever backward to allow backrest tilt. Return the lever to the centre to lock backrest, total 4 positions locking

## PROTECTING LUMBAR POSITIONS ADJUSTMENT

### To adjust lumbar positions:

Hold both sides lumbar positions adjustment handles and lift upwards slowly to increase the lumbar positions to give the most comfortable whole-line support to each user's full spine and lumbar area. There are total 7 levels adjustable

### To reduce lumbar positions:

Lift the handles “ ” to the top and push down, the spine will return to the original position, then adjust to the optimal positions by lifting the handles slowly

**Attention:** in order to operate more easily, you'd better not lean the bionic spine when doing this adjustment





**4** FUNCTION CONTROLS    **ARMREST & SEAT DEPTH ADJUSTMENTS**

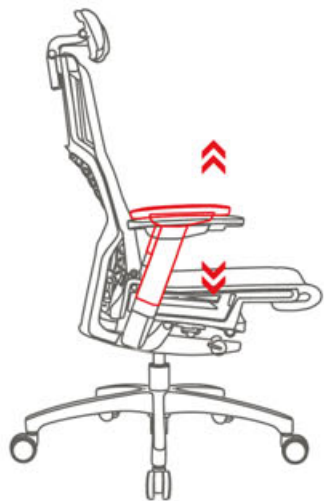

HEIGHT



DEPTH



ANGLE

**« SEAT DEPTH »**

Hold the both sides seat front edge, slide forwards or backwards to increase or reduce seat depth



# LIVEMOTION

## LUMBAR AUTO-TRACKING SYSTEM

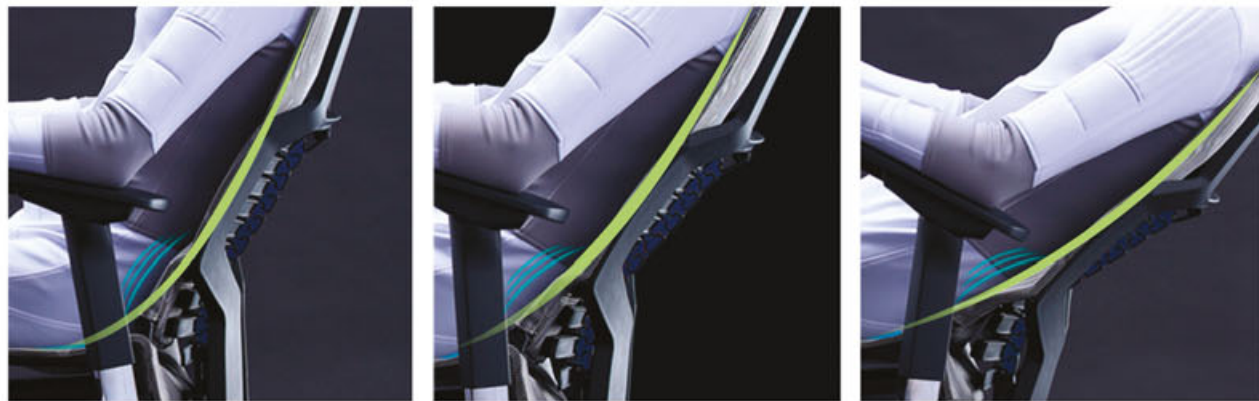

### 5 LIVEMOTION LUMBAR AUTO-TRACKING SYSTEM

Delivers full support and superior comfort to user's lumbar & sacrum area when the user changes sitting posture. Users' lumbar can be supported fully and automatically all the time in any sitting positions



**1D** Height Vertical adjustment  
Suitable for mid-height people



**2D** Height Setting adjustment  
Suitable for taller people



**3D** Tilt adjustment  
Suitable for different body type people



**4D** Angle adjustment  
Suitable for various working needs



**5D** Shape auto-adjustment  
Auto-adjust to suit for different head size and shape

### 1D Height Vertical adjustment

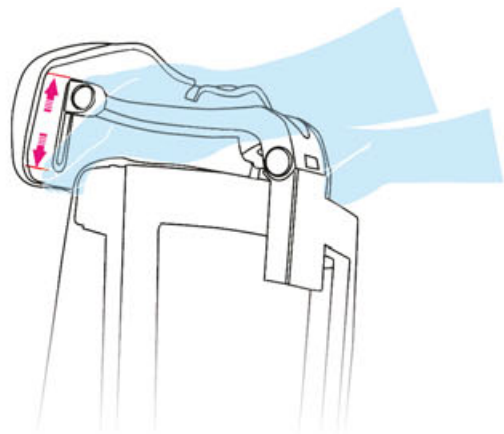

Holding both sides of headrest and pushing headrest up or down to adjust the height

### 2D Height Setting adjustment

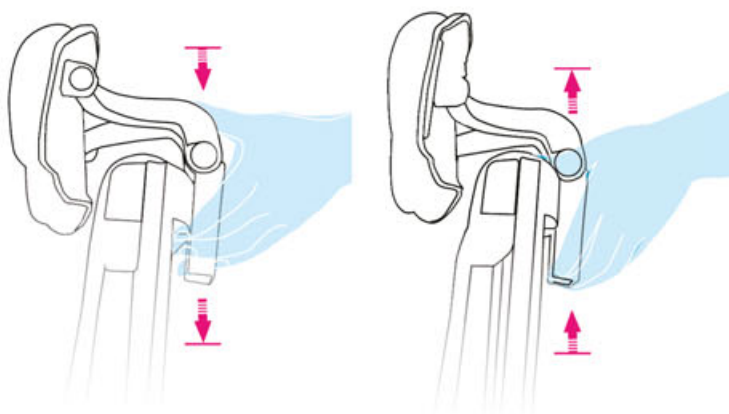

Holding the headrest support bar and pushing the bar up or down to adjust and set the height

### 3D Tilt adjustment

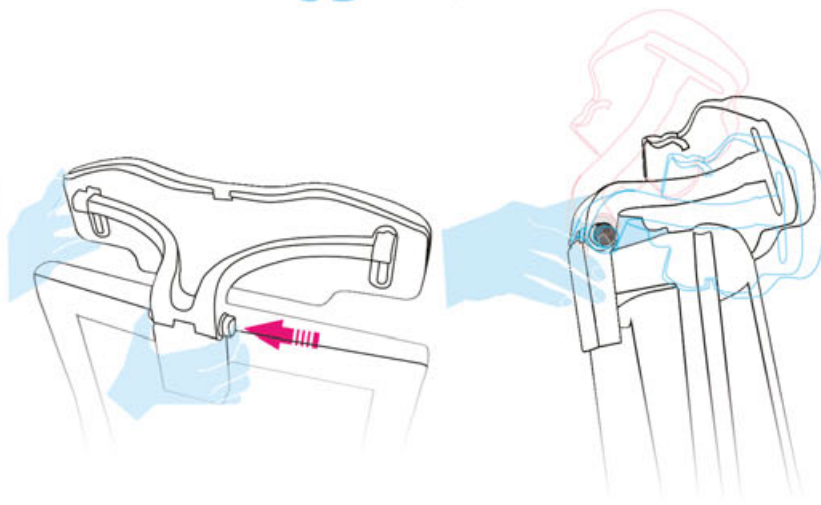

Pressing the button on the right side of headrest support bar when seated and pushing the headrest forwards or backwards to tilt the headrest. Release the button to lock the position

### 4D Angle adjustment

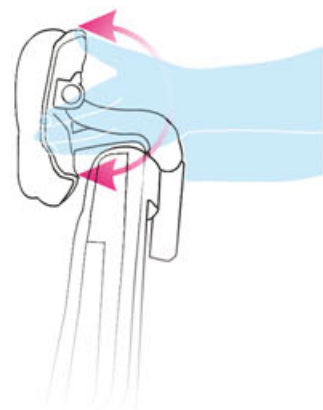

Holding two sides of the headrest and rotate forwards or backwards to adjust the angle



## HEALTHY LUMBAR POSITIONS SETTING GUIDANCE

### Male

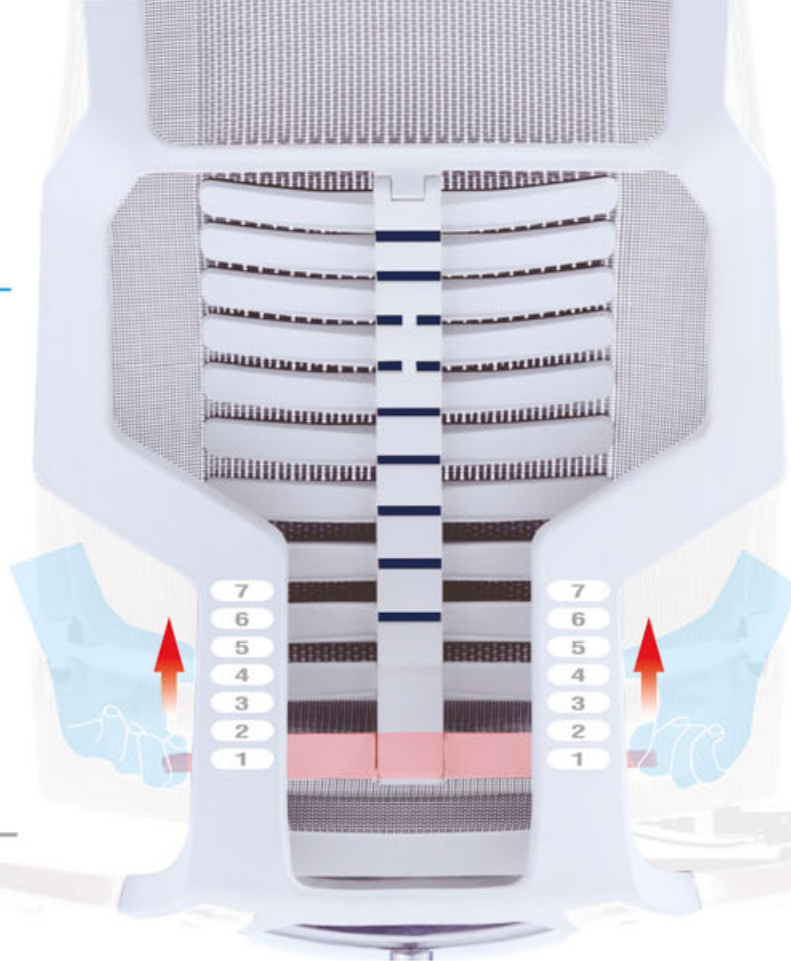
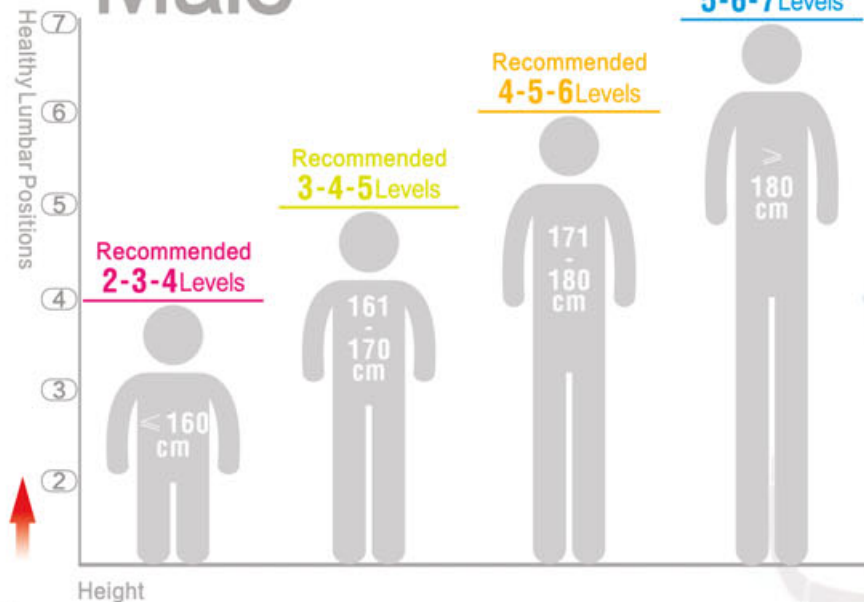

\* You can adjust bionic spine positions by yourself according to different body status when seated. If your lumbar & back spine are more tired, you can adjust bionic spine to 1 position higher than recommended ones to increase spine support. When adjust to recommended position, you can reduce 1 position if you feel too much support on spine

### Female

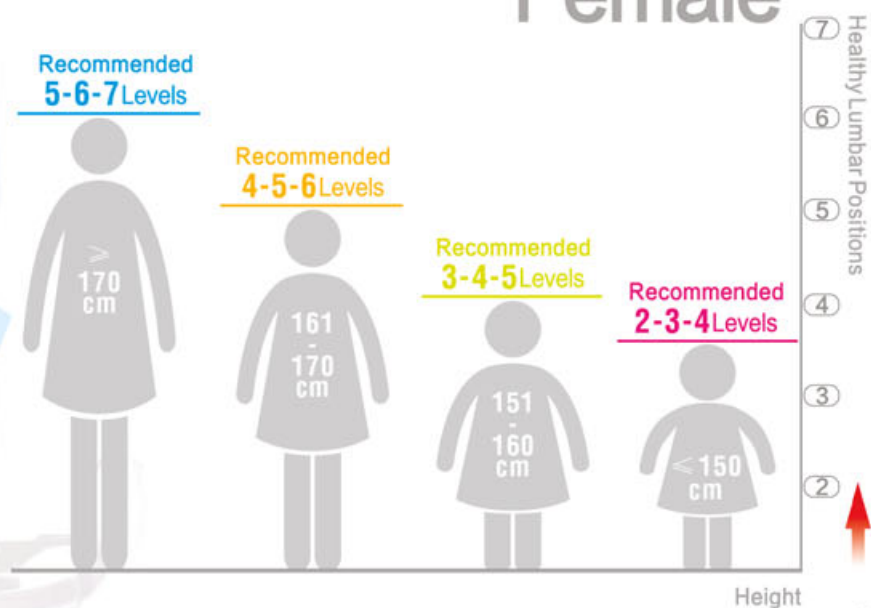

### Correct Sitting Posture

Sitting on seat cushion fully (your hips should touch chair's back) is the most important key to provide full and correct support to back, hips and legs

- 1 Keep head & neck straight to lean headrest, eyes look straight and ahead
- 2 Body lean backrest, ensuring good back support
- 3 Keep the elbow bend at 90° position and hands drop naturally, relax your shoulders
- 4 Keep knees bend at 90°
- 5 Keep 5~8cm between seat front edge to behind knees
- 6 Feet flat on the floor or on a footrest



### Neck support

Pofit 5D (double height, tilt, angle & shape) adjustable headrest can provide multi-directional support to your neck and reduce pressure on your neck

### Back support

Bionic spine is the best solution for back pain. It can provide 300% more whole-line support to your thoracic spine, lumbar spine and sacrum spine

### Lumbar support

LIVEMOTION lumbar system can provide automatically full and superior support to your lumbar area to solve empty lumbar when reclining

### Arm support

3D Armrest allows forearms to be supported and rested comfortably when using keyboard or mouse or reclining to prevent empty arms

### Hips support

Pofit intelligent seat can deliver comfortable and breathable support to avoid hips pain and hot feeling for long-term sitting

### Thigh support

Front seat depth adjustment suits different height users and give good support to thighs. It can disperse pressure on hips to contribute to body blood circulation

# HEALTHY & SMART APP

## 1 APP SETTING

-  DOWNLOAD  LOGIN 29-30

## 2 USE & ADJUSTMENT

-  CREATE PROFILE  CONNECT  LUMBAR PROTECTION SETTING 31-34

## 3 UBIQUITOUS HEALTHCARE

-  FUNCTIONS OF THE HOME PAGE 35-36
-  HEALTHY SITTING POSTURE WARNING 37
-  SEDENTARINESS WARNING 38
-  SITTING POSTURE EVALUATION 39
-  SITTING POSTURE STATISTICS 40

## 4 FACILITIES MAINTENANCE

-  SETTINGS  FAQ 41-43

# THE WORLD FIRST CHAIR WITH SMART APP





# 1 APP SETTING

DOWNLOAD 

## DOWNLOAD



Apple store



Android platform

Search  COMFORT SMART +  
and **download APP**

 In order to achieve APP smart functions, please set you smart phone authority management

**APPLE**  Settings-Notice-COMFORT SMART-Allow notice

**ANDROID**  Settings-Application Management-COMFORT SMART-Notice- Turn on lock screen display

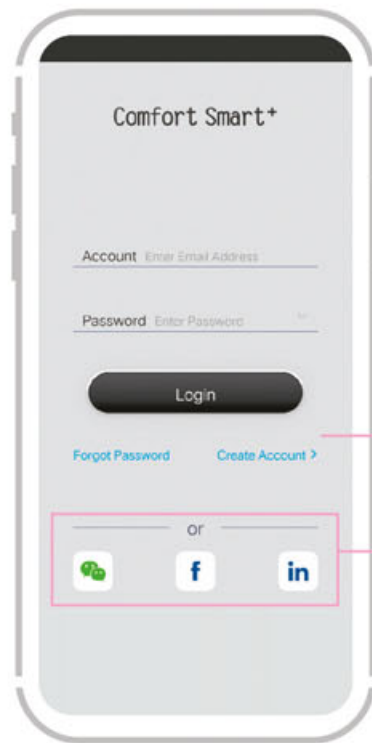
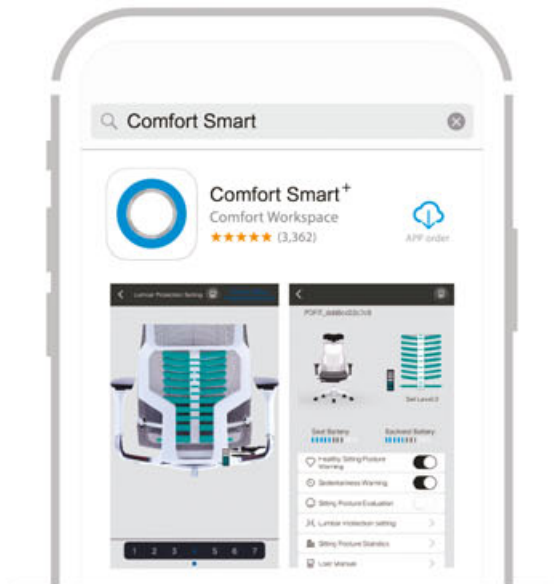

## 2 WAYS TO LOGIN

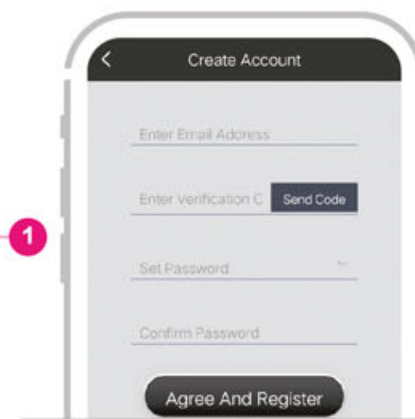

## CREATE ACCOUNT

For 1st time to use app, please register account by mailbox to get verification code and set password

OR

**2** Log in via the third-party (WeChat, Facebook or LinkedIn) at the first time, get the personal information automatically, and then turn to "My Profile" (For details of personal information, please refer to P-31)



 LOGIN



**CREATE PROFILE**

Enter your personal information

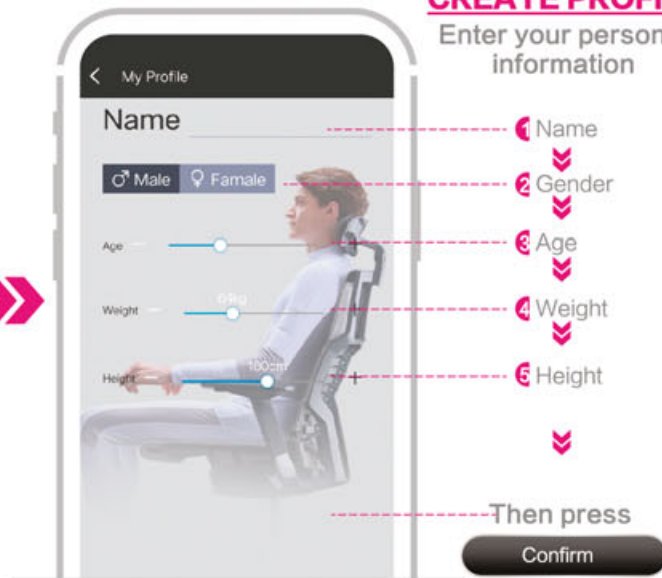
AFTER LOGGING IN 

1 Name

2 Gender

3 Age

4 Weight

5 Height

Then press  
Confirm**Turn On Bluetooth**

Make Sure Your Bluetooth Is Turned On

I Know

Set Up

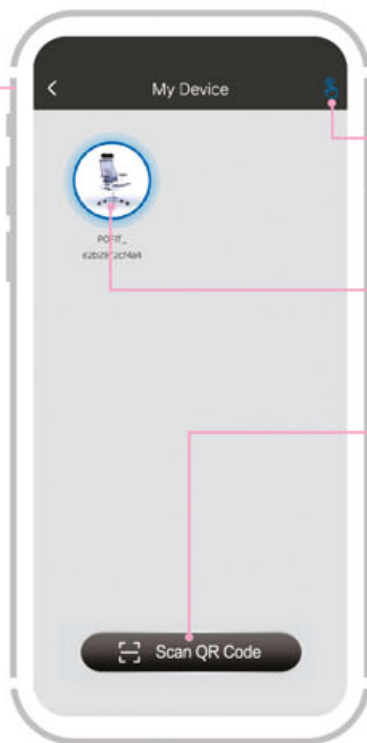
Remind to **turn on** bluetooth **CONNECT**

3 ways to connect your Pofit chair

or  Connecting by entering ID code Connecting by BluetoothRECOMMENDED or  Connecting by scanning QR code

\*For more than 2pcs Pofit with APP nearby, recommend to scan QR code for more exact connection



The QR Code and ID No. are stuck on the seat battery box cover

## 2 USE & ADJUSTMENT

### LUMBAR PROTECTION SETTING

App can guide users to adjust to best comfortable lumbar support position through large data analysis to maintain users' health



#### Situation A Suggested Levels

Lumbar levels are within comfortable ones  
The bionic spine becomes **green**

You can confirm this level if you feel the level is the best comfortable one. Also you can experience other levels to find the best proper one and press "Level Confirmation" button

to save

**Level Confirmation**  
Save this level as the most comfortable level



#### Situation B Too High Levels

Lumbar level is too high  
The bionic spine becomes **yellow**

APP will advise you to adjust lumbar level down to the suggested levels. Also you can try other levels to find the best comfortable level and confirm it. Once you got the most comfortable level, then confirm

to save

**Level Confirmation**  
Save this level as the most comfortable level

#### For Adjust Bionic Spine

To reduce bionic spine position, lifting the handles to the **Top(7th level)** and pushing down to the 1st level, then adjust to the recommended level



#### Situation C Too Low Levels

Lumbar level is too low  
The bionic spine becomes **red**

APP will advise you to adjust lumbar level up to the suggested levels. Also you can try other levels to find the best comfortable level

to save

**Level Confirmation**  
Save this level as the most comfortable level



When finished all settings, login app to access to functions home page directly

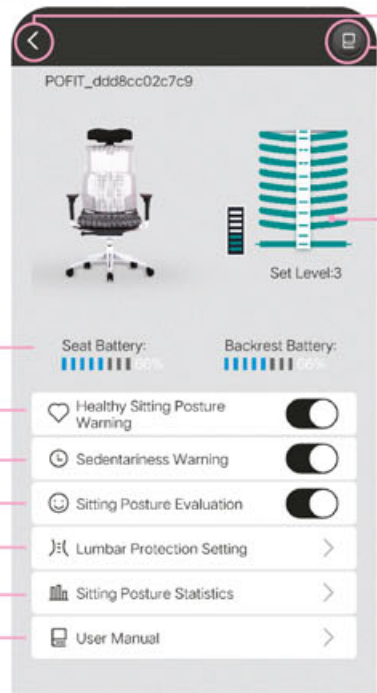

2 Seat & Back Power Display

3 P-37 Healthy Sitting Posture Warning

4 P-38 Sedentariness Warning

5 P-39 Sitting Posture Evaluation

6 P-33-34 Lumbar Protection Setting

7 P-40 Sitting Posture Statistics

8 User Manual

1 P-33-34 3 situations of set level

A **GREEN** when lumbar support is at the recommended level

B **YELLOW** when lumbar support is above the recommended level

C **RED** when lumbar support is below the recommended level

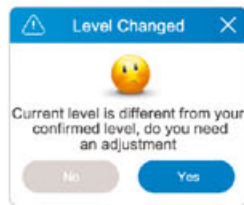

When APP detected **lumbar levels have been changed**, APP will send a reminder. If press "YES", direct access to "Lumbar Protection Setting"

### 9 HEALTHY SITTING POSTURE GUIDE

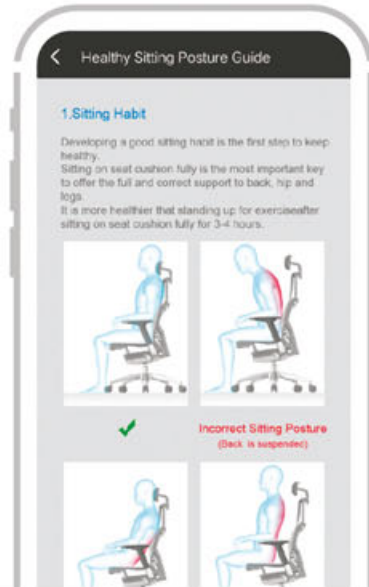

### 10 CONNECTED CHAIRS DISPLAY AREA

When reach the home page functions, click "back" to access to this connected chairs show area. This page can add (click ) and switch connection with other Pofit chairs quickly. This area will record and display all connected chairs

### UNBIND MY CHAIR

Long press Pofit chair picture to unbind the chair. If confirm "unbind", the chair do not appear on the display area. It does not connect automatically the unbound chair when login again. You need to re-connect the chair to re-bind it.

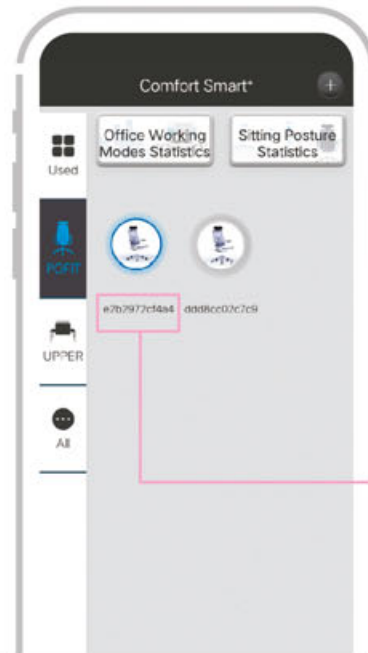

please input nick name

Cancel Confirm

Long press chair name to revise your chair name. Connect successfully if the picture circle becomes **blue**

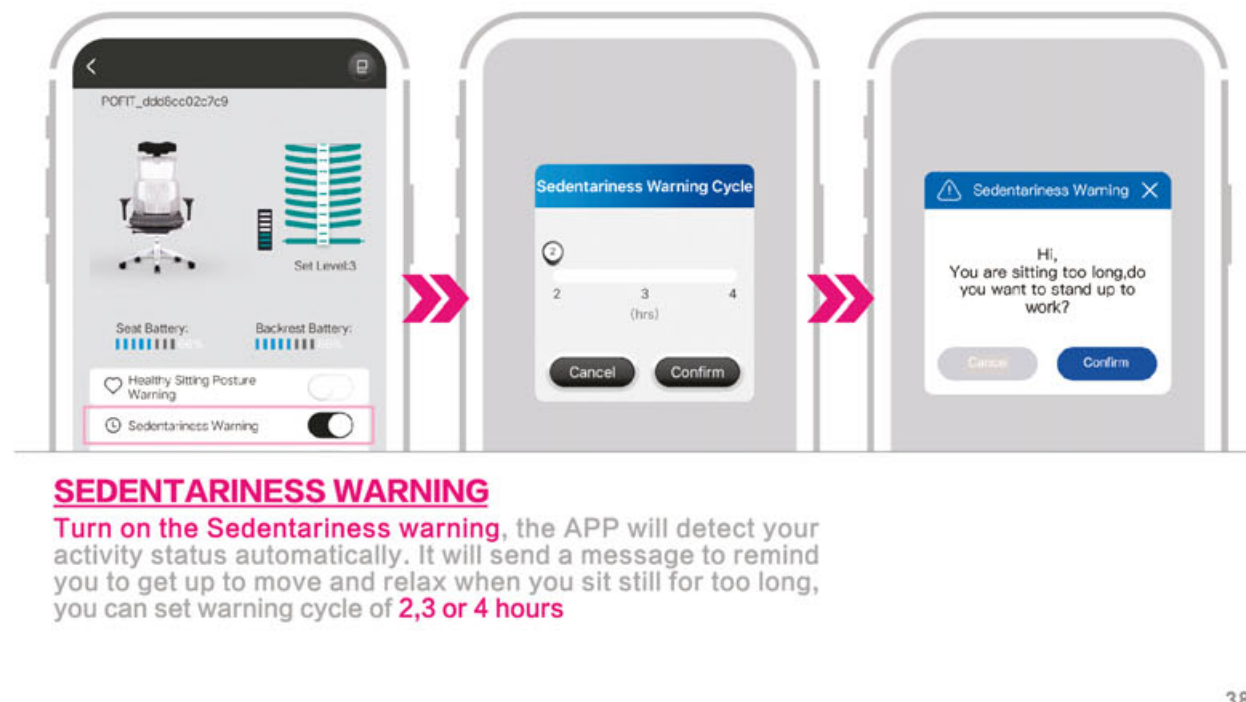
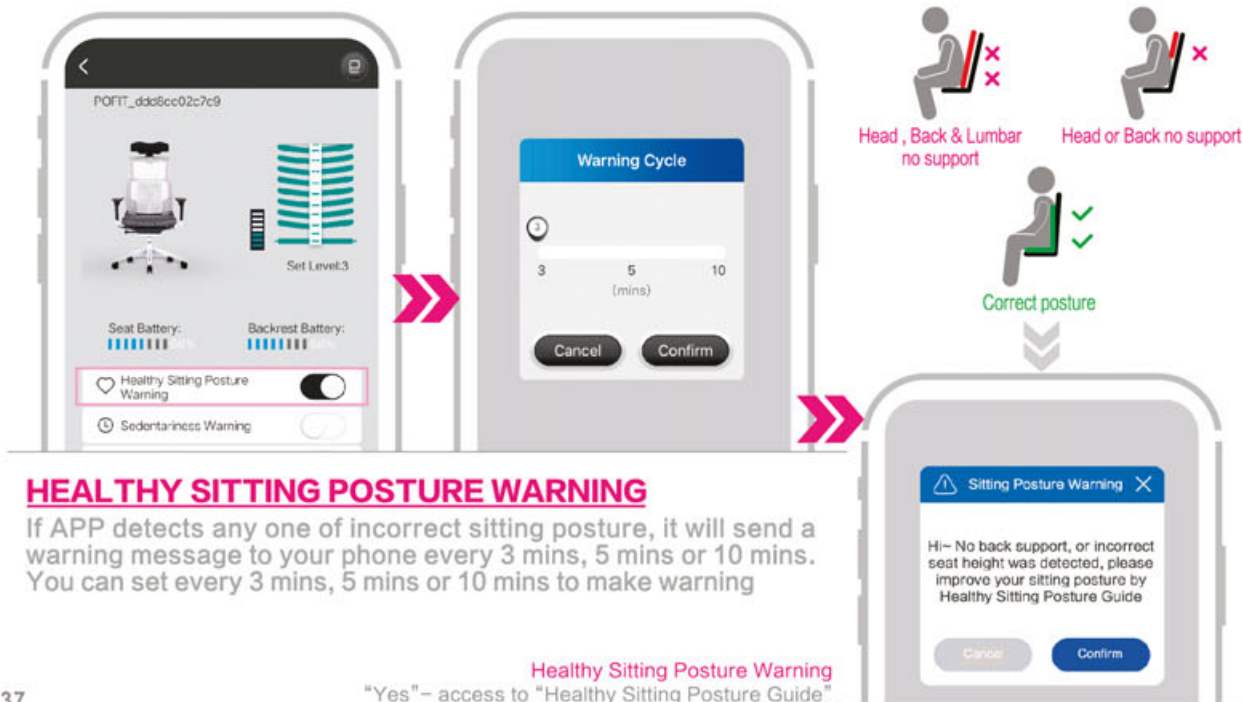





### SITTING POSTURE EVALUATION



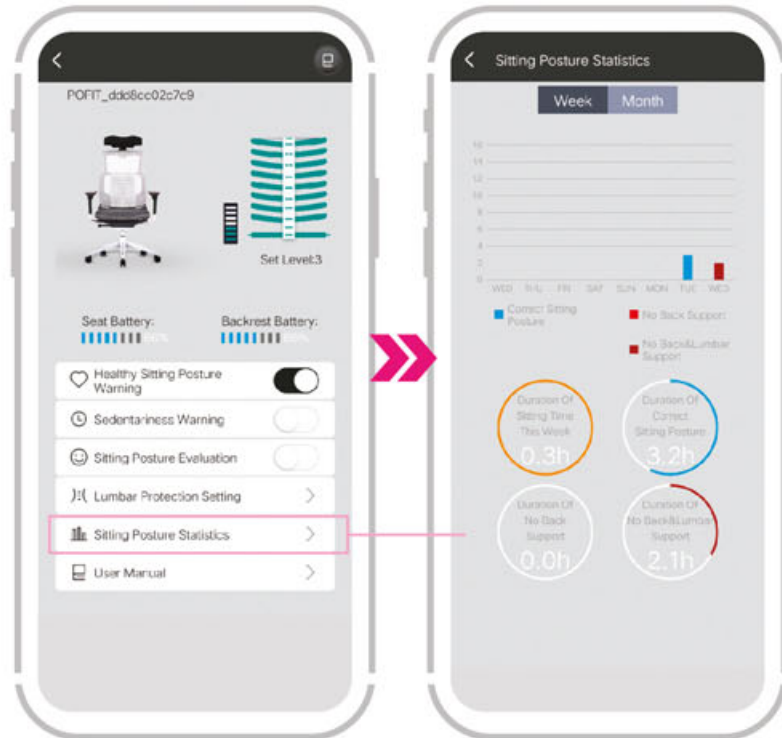



Turn on the function of sitting posture evaluation. APP will calculate how much time you sit correctly and how much time you sit wrongly every 3~8 hours and will send a evaluation message to your phone. This function can help users to develop a good & healthy sitting habit

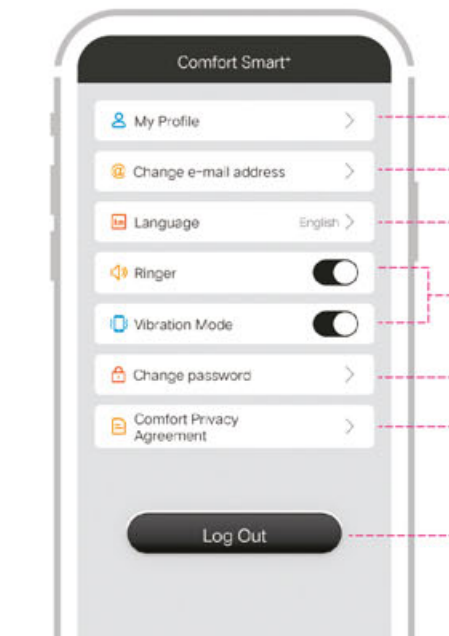

### SITTING POSTURE STATISTICS

Review the sitting posture status in one week or one month via "Sitting Posture Statistics". It records the total sitting time, correct sitting posture time, and 2 types of incorrect sitting posture time: no head or back support and no head, back & lumbar support

**SETTINGS**

-  Review & revise personal information
-  Change e-mail address
-  Language: Chinese, English, Japanese, Spanish, Korean
-  Turn on the Ringer and Vibration to get the sitting posture status in time, never miss any healthy reminders
-  Change password
-  Comfort Privacy Agreement
-  You can switch account after logging out

**1. No device be found, or cannot connect the device**

- Sit on the chair, and lean on the backrest to awake both seat and backrest device
- Make sure the Bluetooth is turned on, close the handset to the chair, unobstructed internet with no interference
- Remove the seat batteries to restart the device
- Restart "Comfort Smart+"
- Restart your handset
- Your chair could be connected by others, if you still cannot connect the device

**2. Cannot connect the historical chair in "My Chair"**

- Long press the icon to unbind the historical chair, and then connect the chair again

**3. After connecting successfully, the display of current level (in "lumbar protection setting") doesn't change when user adjusts the lumbar support?**

- Based on the stability of Bluetooth technology, data transmission may be delayed after the first successful connection. Everything will be back to normal within 20s
- Backrest may not be awakened, please lean on the backrest to awake the backrest device

**4. Battery level goes to "0" suddenly**

- Seat and backrest devices would enter hibernation without any use in 5 minutes, please Sit on the chair, and lean on the backrest to awake the devices

**5. No automatic connecting to the historical chair?**

- Make sure "Comfort Smart+" is running in the background
- App will connect the chair used in the last automatically

**6. No connection during using the app?**

- Seat and backrest devices would enter hibernation without any use in 5 minutes, please Sit on the chair, and lean on the backrest to awake the devices
- Restart "Comfort Smart+"
- Remove the seat batteries to restart the device
- Your chair may be connected by others when your app is disconnected

**7. Did not receive the verification code, please check your junk mail.**

\* If the above questions can not be solved, please contact your local dealers



3 incorrect operations may cause **bionic spine retroflexion**

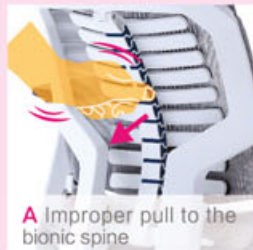

**A** Improper pull to the bionic spine



**B** Improper push to the backrest



**C** Extra pillow beside the backrest



**Bionic spine retroflexion**



**Solution:**

When there is a bionic spine retroflexion, push the bionic spine lightly to get it back to the normal shape and structure. No functional failure





## CARE & MAINTENANCE

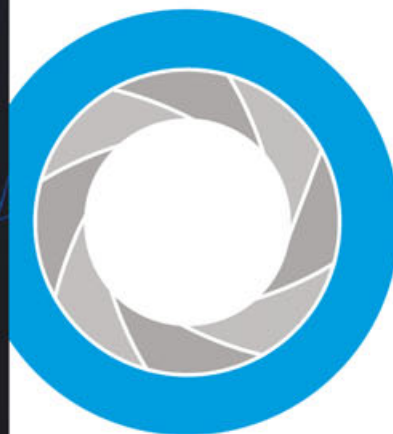
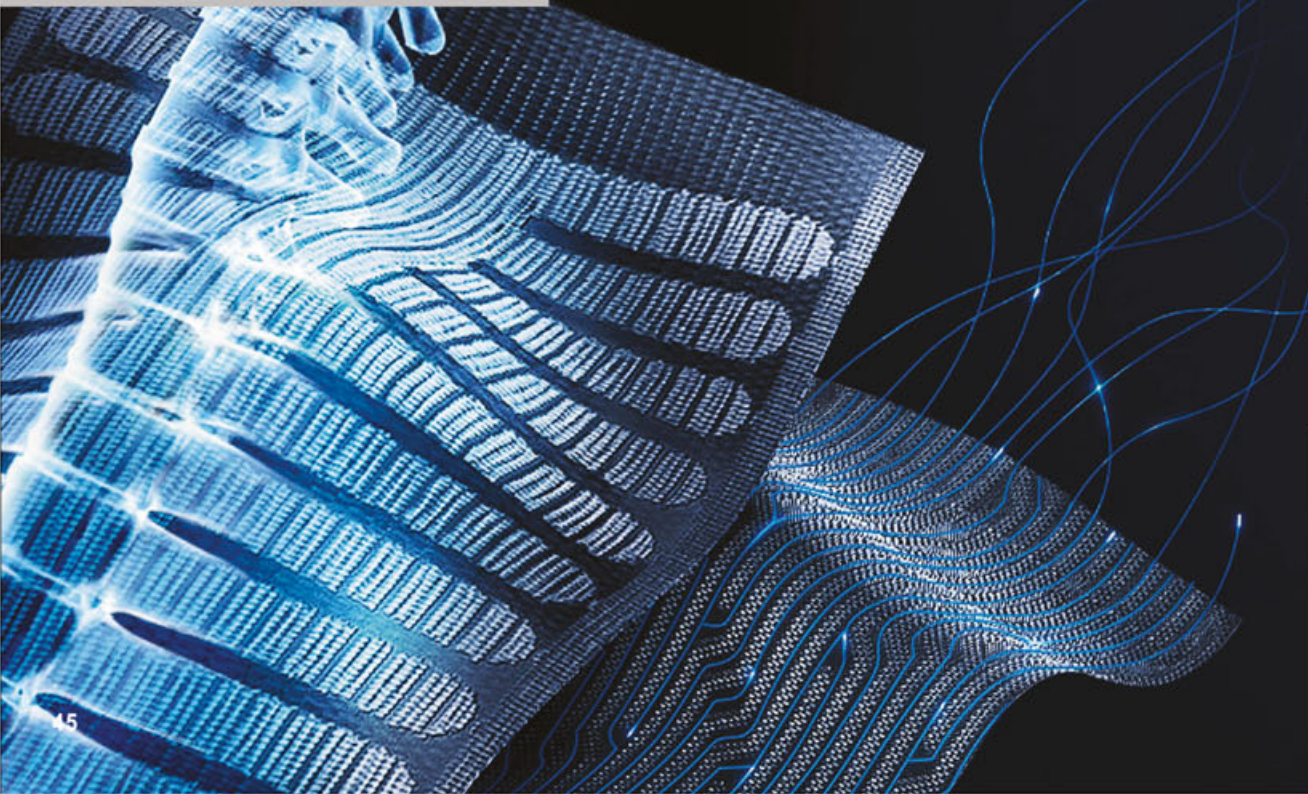

### **UPHOLSTERY**

Use a soft cloth with a little clean water to wipe  
DO NOT use solvents or petroleum based products to clean

### **WARRANTY:**

The warranty applies to defects caused by normal use and does not cover maintenance, modifications or tampering

Comfort will not be responsible for damage caused by or associated with the installation and/or use of products in any manner other than in strict conformance with the instructions set forth in its installation manuals and instruction sheets and/or product literature

Warranties are non-transferable

Note: The polish line on aluminium base and welding line on plastic outer frame are part of the normal manufacturing process

**For more information , please contact your Comfort Workspace Dealership**